



PRODUCT FEATURES

- DC Carbon Brush Motor
- Direct all steel gear driven transmission
- 10 variable Speeds
- Rigid cast aluminum body
- 5 litre stainless steel bowl
- Polycarbonate bowl safety guard
- Safety interlocked bowl lift
- Overload reset button for motor protection
- White with gold epoxy enamel finish
- 1.8m cord with plug

STANDARD ACCESSORIES

- 5 litre bowl (stainless steel) Ref # 5A04
- Beater (aluminium) Ref # 5A02
- Whisk (stainless steel) Ref # 5A01
- Dough hook (aluminium) Ref # 5A03
- Bowl safety guard (polycarbonate) Ref # 5AE01

OPTIONAL ACCESSORIES

- Bowl safety guard (stainless steel) Ref # 5E01-SUS

TECHNICAL DATA

Power	800 Watts	1/4 HP
Electrical data	240V/50/1	Draw 2 Amps
	Single phase - plug supplied	
Variable Speed	60 to 260 rpm	
Dimensions (LxWxH)	389 x 345 x 434 mm	
Gross weight	15 kg	
Reference	SP502A-C	

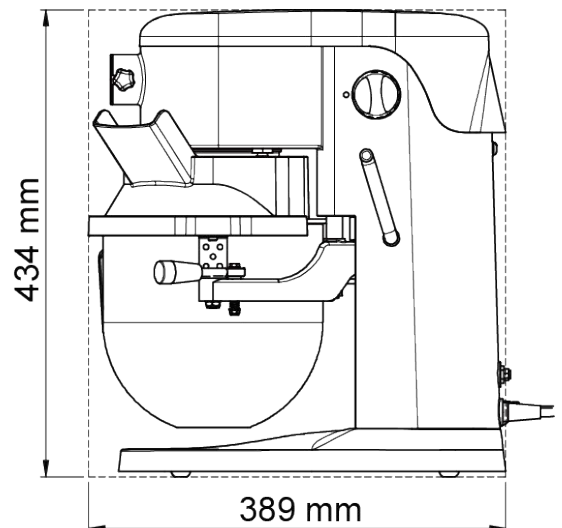
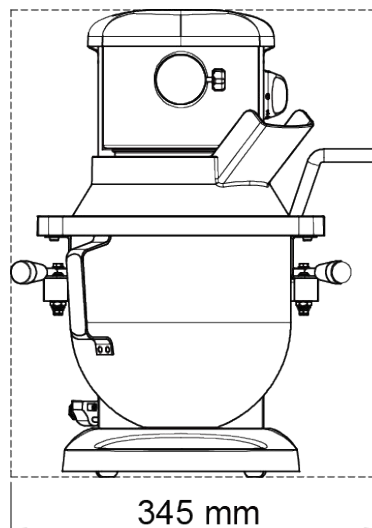

STANDARDS

